

1969 AIRSTREAM MODELS

SPECIAL LAND YACHT SERIES

The 18' Caravel and 21' Globetrotter will be produced in a new Special Land Yacht Series to be introduced by January, 1969.

THE DELUXE LAND YACHT SERIES INCLUDES AS STANDARD EQUIPMENT:

30 Gallon water tank
Univolt water pump
Sewage holding tank
Electric/Gas refrigerator
10 Gallon gas water heater

Built-in 12V battery
Battery charger and voltage regulator
Univolt interior lighting system
2 - 12 volt outlets
Back-up lights

Bathroom ceiling fan
Toilet hand spray
Stainless steel galley sinks
Double 5 gallon gas bottles
Bedspread on fixed beds
Natural-toned ash woodwork

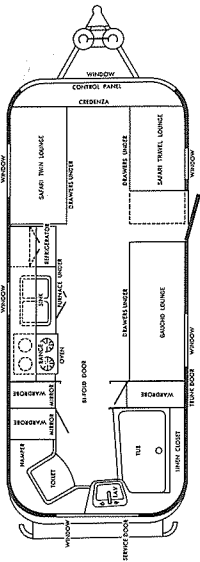

23' SAFARI

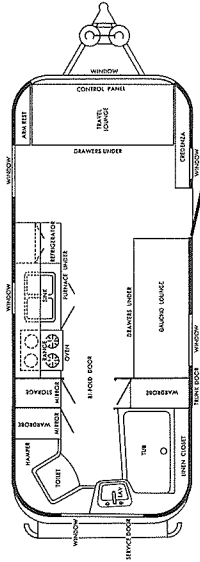

25' TRADEWIND

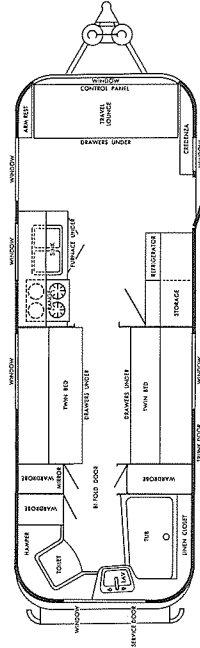
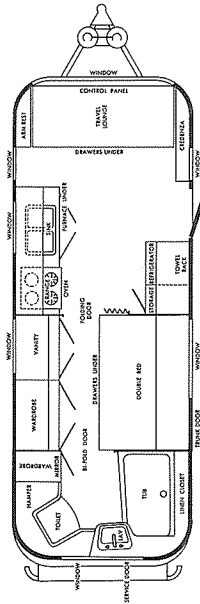
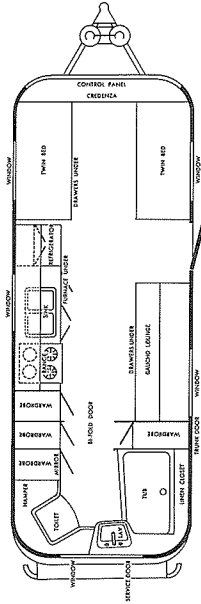

27' OVERLANDER

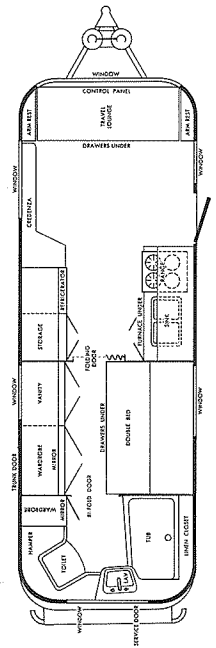

THE INTERNATIONAL LAND YACHT SERIES INCLUDES AS STANDARD EQUIPMENT:

30 Gallon water tank
Univolt water pump
Sewage holding tank
Electric/Gas refrigerator
10 Gallon gas water heater
Built-in 12V battery
Battery charger and voltage regulator
Deluxe central control panel
Univolt range exhaust fan

1 Univolt ceiling fan
Univolt interior lighting system
2 - 12 volt outlets
Back-up lights
Bathroom ceiling fan
Double 7 gallon gas bottles
Automatic gas bottle regulator
Water purifier
Stainless steel galley sinks

Deluxe plumbing hardware
2 sink covers with cutting boards
Toilet hand spray
Bedspreads on fixed beds
Bedroom wall comfort cover
Deluxe hub caps
Astrodome
Walnut woodwork
Herculon carpet or vinyl tile

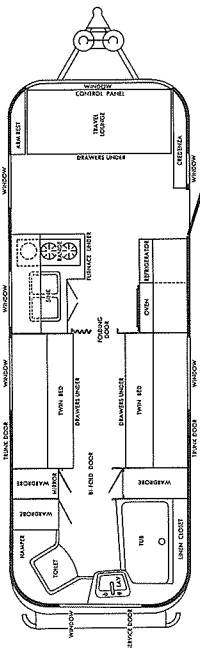

27' OVERLANDER

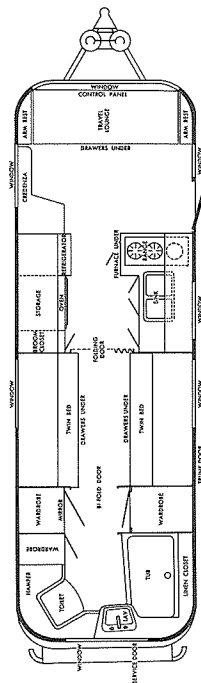
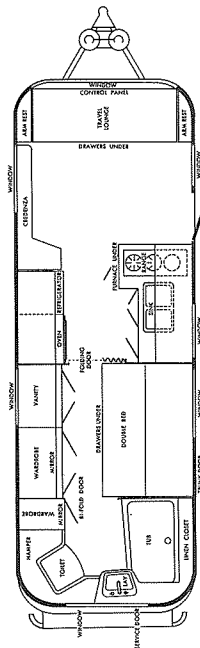

29' AMBASSADOR

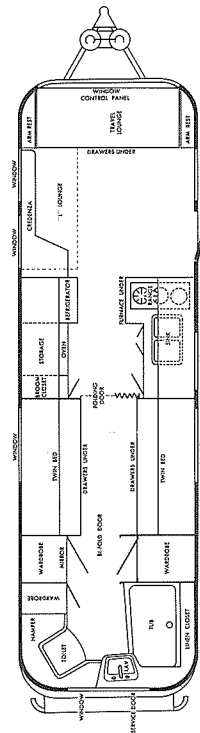
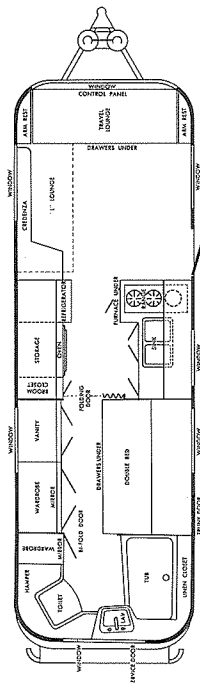

31' SOVEREIGN OF THE ROAD

