

THE 1963 AIRSTREAM FLEET

WIDEST CHOICE OF MODELS IN THE INDUSTRY

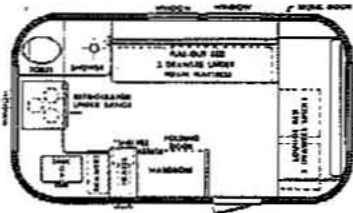

16 FT. BAMBI

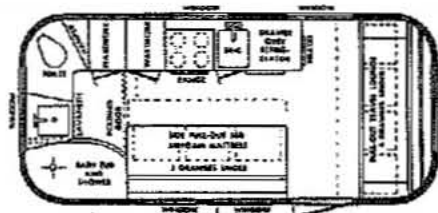

19 FT. GLOBE TROTTER

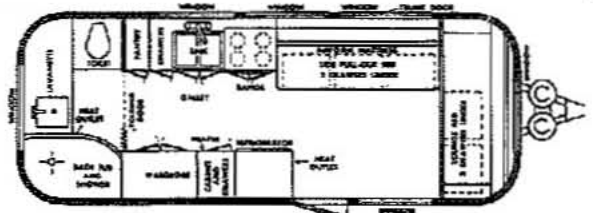

22 FT. FLYING CLOUD
(Built for Three)

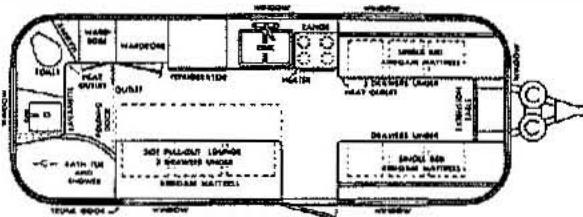

22 FT. SAFARI TWIN

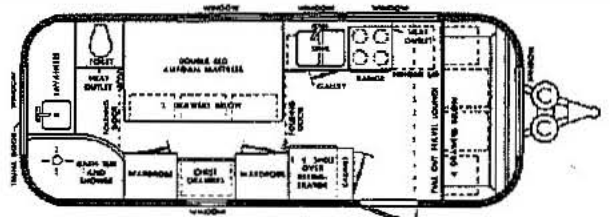

22 FT. SAFARI DOUBLE

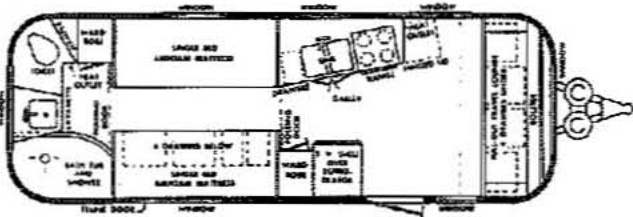

24 FT. TRADEWIND TWIN

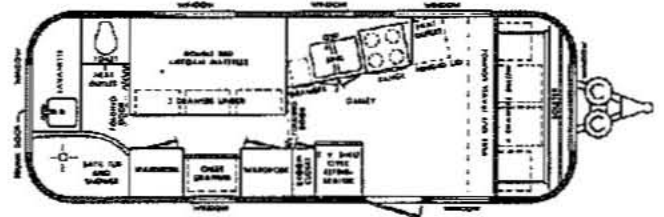

24 FT. TRADEWIND DOUBLE

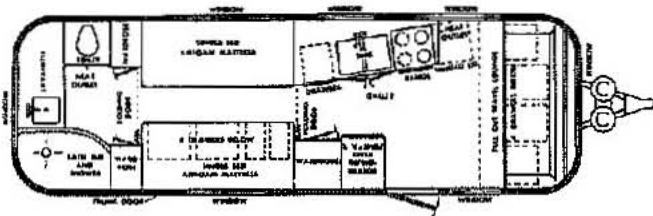

26 FT. OVERLANDER TWIN

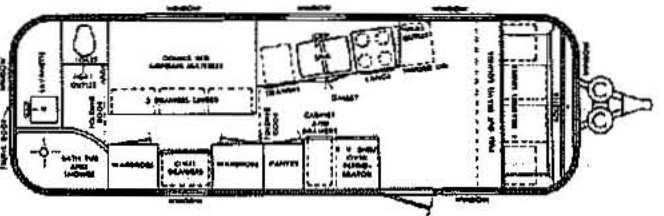

26 FT. OVERLANDER DOUBLE

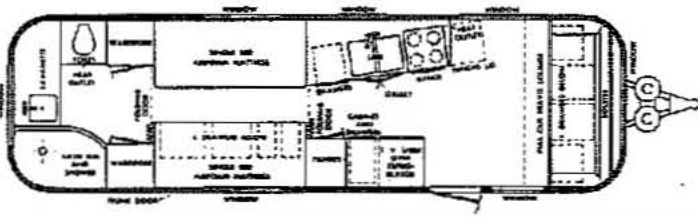

28 FT. AMBASSADOR TWIN

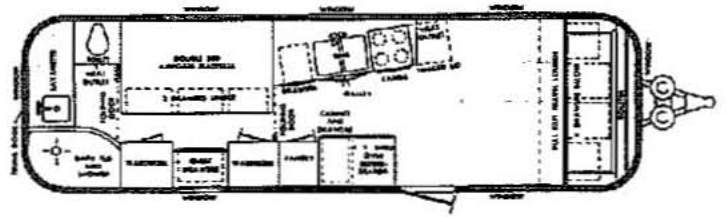

28 FT. AMBASSADOR DOUBLE

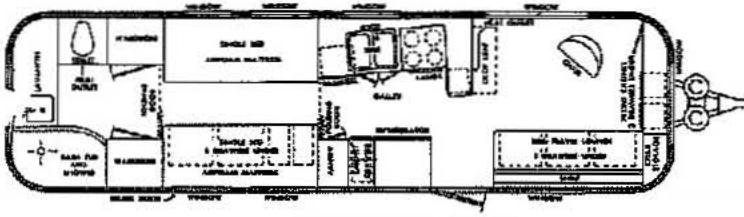

30 FT. SOVEREIGN TWIN

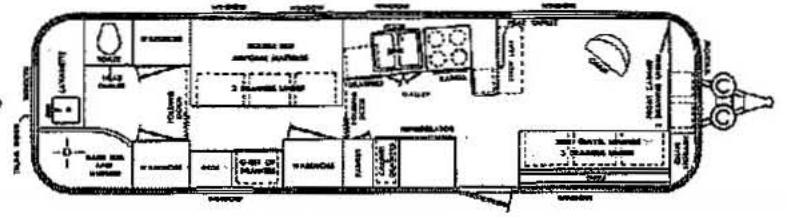

30 FT. SOVEREIGN DOUBLE

THE 1963 AIRSTREAM

The 1963 Airstream fleet is representative of continued refinement that must take place in a product when it's manufacturer is so close to its use. The famous streamlined Airstream shape is even made cleaner with flush trunk doors and recessed window drip caps. All models have enlarged window areas. An improved sewer hose carrier is standard equipment. The exclusive Dura-Torque axle is further strengthened with additional axle loading capacity. There is greater galley storage in all models and additional front room space in most.

Airstream, which pioneered self containment, establishes another industry first in 1963 by building only self-contained trailers. Every Airstream in the fleet this year comes standard equipped with at least a pressure water system (with a new water gauge to tell you how much water is in your tank), battery operated compressor, septic tank (which has an improved emptying valve), gas refrigerator (with a greater cooling capacity and fully seventy pounds lighter), gas water heater, twelve volt battery, twelve volt lights as well as 110 volt lights throughout, a water-saving toilet hand spray, a sewer hose carrier, and an automatic switch-over bottled gas regulator. *And the luxurious International line of Airstream Land Yachts is even more exquisite in 1963.* New stainless steel galley sinks, insulated vinyl bedroom wall covering, deluxe bathroom and kitchen hardware, a hand spray at the galley, and the finest in upholstery and vinyl tile flooring together with all of the standard International Series equipment add up to the ultimate in travel trailers.

Another major engineering improvement is in making these units as weather proof as possible. The improved insulation, re-aligning of the entire plumbing profile, easier lighting on the greatest capacity space heater in the industry, heated battery box installation, and an improved drainage system make Airstream, more than ever before, an absolutely all-weather trailer.

1963 AIRSTREAM FLEET PRICE LIST Effective August 1, 1962

Model	International*	Land Yacht†
22' Flying Cloud	\$5876.00	\$5195.00
22' Safari (twin or double)	5876.00	5195.00
24' Tradewind (twin or double)	6259.00	5540.00
26' Overlander (twin or double)	6927.00	6232.00
28' Ambassador (twin or double)	7167.00	6700.00
30' Sovereign of the Road (twin or double)	7808.00	7145.00

*International Models include as Standard Equipment:

✓Septic tank	Stainless steel galley sinks	Deluxe plumbing hardware	✓All interior lights 12V-110V
✓Gas refrigerator	Galley spray	Bedspreads	12V-110V range exhaust fan
✓Gas water heater	Toilet hand spray	Bedroom wall comfort cover	12V outlet
✓Battery	Galley wall cabinet	Police type radio antenna	1 12V-110V ceiling fan
1 Solardome	Extra sink cover	✓1 hose carrier	Double 7 gal. gas tanks
✓Compressor	✓Automatic tank regulator	1 12V flood light	Deluxe hub caps
Water purifier	✓Pressure water system	1 110V ceiling fan	

The International Line is further distinguished by its deluxe interior appointments . . . walnut-stained oak cabinets, vinyl floor tile, exquisite upholstery with harmonizing, lined curtains and slide-on curtain attachments.

†Land Yacht Models include as Standard Equipment:

Pressure water system	Gas refrigerator	12V Compressor	Double 5 gal. butane tanks
Septic tank	Gas water heater	Toilet hand spray	Automatic tank regulator
All interior lights 12V-110V	Built-in 12V battery	Hose carrier	Lined curtains

Limited Production, Self-Contained Models

16' Bambi	\$3190.00
19' Globe Trotter	4195.00

These Two Models include the following Equipment as Standard:

Pressure water	Gas refrigerator	Battery	Toilet hand spray	Hose carrier
Septic tank	Gas water heater	Compressor	All interior lights 12V-110V	2 - 5 gal. gas tanks

And tax?

List of 1963 Improvements

All Airstreams completely self-contained — Automatic Circuit breaker in 12 Volt system — Automatic Circuit breaker in 12 Volt charge line — Bedroom ceiling light — Heated, built-in battery box installation — Exterior Current Outlet located next to water inlet — Heated septic tank — Inside drain line valves — Improved septic tank outlet valve (3") — Separate, low hose fill for water system — Lower hand-fill for water supply — Enlarged air vent on pressure tank — Water gauge on pressure tank — Increased axle capacity — Sealed venting for gas refrigerator — 100 Lb. lighter gas refrigerator — Tappan range and oven with window.

New "soft" angle galley in 24, 26, and 28 foot models (provides additional top galley space and additional galley storage space) — Enlarged tow kicks at galley and lavatory — Drip-lip on galley and lavatory tops — Lined curtains in all models — Improved curtain-hanging attachment — Cafe curtains at stacked windows — More easily-serviced water purifier — New free-form bathtub designed for more complete drainage — Foamed bathtub base for complete tub insulation — New medicine chest — Additional window area in most models — Stacked windows forward of the door in 24' Twin bed TRADEWIND — Large bathroom in 26' twin bed OVERLANDER — Drain holes in main step — Flush main door eyebrow — Flush window eyebrows — Flush screen door — Flush trunk doors — New sewer hose carrier — New spare tire mounting.

AND IN THE INTERNATIONAL MODELS: Deluxe single control water faucets — Galley hand spray — Stainless steel galley sinks — Vanity table mirror in double bed models — Vinyl-foam "comfort cover" on bedroom walls — 12V-110V Range exhaust fan.

NEW OPTIONALS: 12V-110V Bathroom exhaust fan — 12V Stereo tape set — 12V Transistorized Motorola radio.

AIRSTREAM OPTIONAL EQUIPMENT LIST, 1963 MODELS

Optional Groups		Galley Formica Splash		TV Jack only	
DeLuxe Group	\$67.50	Panel	18.00	TV Swing Shelf	20.00
12V-110V Ceiling Fan	30.00	Sink Cover (single)	3.15	Gas Light	20.00
*2 - 7 gal. Gas Tanks	15.00	General Optionals		Spare Wheel and Tire	
*1 Solardome	11.25	*Pull-out Double Size Bed	\$81.25	Assembly: 6-ply Nylon	56.25
1 12V Floodlight	11.25	*Bunk	37.50	8-ply Nylon	62.50
Road Group	\$34.65	Bunk Mattress, Foam	56.25	Spare Wheel Installation	
1 - 10' Sewer Hose	8.40	Water Purifier	70.00	Bracket with Spare	
25' Water Hose	4.45	12V Outlet	12.50	Tire Cover	50.00
2 - Stabilizing Jacks	8.00	**12V-110V Bathroom		Front and Rear	
Jack Pad	3.75	Exhaust Fan	37.50	Cluster Lights	18.75
Water Line "Y"	2.45	12V-110V Range		†Duo-Therm Air	
Water Pressure Regulator	7.50	Exhaust Fan	37.50	Conditioner	395.00
Decorator's Group—Twin	\$88.15	110V Ceiling Fan	17.50	Double Rib and Wire	30.00
Decorator's Group—Double	63.15	12V Transistorized Radio,		Break-away Switch, Electric	12.50
Bedroom Wall Comfort		Installed (requires po-		Outside Acrylic Coating:	
Cover (each)	12.50	lice-type antenna)	81.25	19'	40.00
Bedspreads, Double	22.50	Police-type Radio Antenna	25.00	22'	42.50
Twin (each)	17.50	12V Transistorized Stereo,		24'	45.00
2 - Pillowcases (bedspread		2 Speakers, Installed	250.00	26'	47.50
material)	7.00	TV Antenna and Jack	42.50	28'	50.00
				30'	52.50

*Price is the exchange price over the cost of the equipment which comes standard in trailer.

**Not available in 16', 19', 22' twin Safari, and 24' twin Tradewind.

†Double rib and wire must be added.

Smiths'

113 LUNENBURG STREET

(Route 2A)

Phone: 343-4750

FITCHBURG, MASSACHUSETTS